



DuraSled™ DS840

Universal Barcode Scanning Sled

- XCover Pro (2020)
- Samsung Galaxy J2 Pro (2018)
- Samsung Galaxy J2 Core (2020)
- Samsung Galaxy J3 (2015 - 2017)
- Samsung Galaxy J3 Pro (2016)
- Samsung Galaxy J3 Emerge (2017)
- Samsung Galaxy J3 Achieve (2018)
- Samsung Galaxy J5 (2015)
- Samsung Galaxy J5 Prime (2016)
- Samsung Galaxy S7 (2016)

The DuraSled™ DS840 is a universal barcode scanning sled for 1D/2D barcodes, with Bluetooth® wireless technology for selected Samsung Galaxy Phones. The DuraSled reads printed or on-screen barcodes. It is easy-to-use and ideal for delivery services, asset tracking, ticketing, and other application-driven mobile solutions. Its rugged case protects phones from drop damage and provides a robust, versatile charging solution suitable for all workplace environments. Simply insert your Phone, pair your scanner and you are ready to go.

DuraSled supports Samsung Galaxy XCover Pro, J2, J3, J5 & S7 Phones. This makes it easy for workers to mix and match DuraSled™ solutions, all while using the same accessories and application. The core components do not change when switching to a new phone model, enabling users to maintain their mobile deployment investments for a relevant number of years.

The Capture SDK enables easy integration into native, and/or web-based applications that use scanning to enhance the productivity of workers using phones.

NOTE: Phone not included.



Features

- **Bluetooth Wireless Technology** - Connects easily to Samsung Galaxy Phones
- **Compatibility** - Supports HID keyboard emulation to work with any application out of the box. Socket Mobile's SDK is integrated in over 700+ applications, and our scanners are one of the most natively integrated scanners available.
- **Scanning** - Fast 2D, 1D and omni-directional ability, allowing intuitively rapid barcode scanning with highly visible and safe LED aimer
- **LED Aimer** - Bright, rectangular illumination field with LED dot for precise aiming
- **Scanner Feedback** – Scanner provides audible scan tones, hand pulsation and Bluetooth indicators
- **Long Lasting Replaceable Battery** - Power to last over 9 hours and battery is field replaceable
- **One-Handed Operation** – Insert the phone for a one-handed scanning solution.
- **Interchangeable Scanner** - Barcode scanner can be used separately, attached to a different phone, or inserted into any model DuraSled (Case Only).
- **Interchangeable Accessories** – All accessories for all DuraSleds models are compatible: Charging Adapter, Single Charging Dock, Vehicle Charger and 6 Bay Charger
- **Integrates connectors from both devices directly into the case for dual charging.**
- **Features magnetic contacts for ease of docking.**
- **Application Integration** – Socket Mobile's Capture SDK enables easy integration in your applications to improve business productivity with fast, efficient, and reliable data transfer over Bluetooth wireless technology.
- **Designed and made in USA**

DURASLED & CHARGING DOCK BUNDLE

- (1) DS840 for Samsung Galaxy
- (1) GDS® Charging Dock
- (1) USB Cable

- Available bundles come with:
- DS840 with Charging Dock
 - DS840 with 6 Bay Charger



Download Socket Mobile Companion app for easy pairing, product registration and more!

OPTIONAL ACCESSORIES

Charging Adapter



Connect your DuraSled to a Snap-Con™ GDS to Micro USB 2.0 Adapter and charge both the scanner and the handheld device at the same time! Perfect for charging at home or anywhere you go.

*Charging Dock



Connect your DuraSled to the GDS® Charging Dock. The exterior docking contacts are specifically engineered for secure docking and charging of both devices in the DuraSled.

*Included with bundle

Vehicle Charging Dock



The Vehicle Charging Dock is a mounted charger for the DuraSled that provides users the freedom to charge their scanner and phone while on the go.

6 Bay Charger



The 6 Bay Charger charges multiple DuraSled devices within a single docking station. This desktop solution is perfect for large offices, conference rooms, vehicle fleets, and other applications requiring mass charging of multiple DuraSleds.

PHYSICAL CHARACTERISTICS

Dimensions	DuraSled for XCover Pro	Weight: 3.84 oz (109.0 g) Size: L 7.25" x H 1.22" x W 3.32" (184.1 x 30.9 x 84.3 mm)
	DuraSled for J2/J3/J5	Weight: Size: L 6.15" x H 1.07" x W 2.91" (156.2 x 27.178 x 73.914 mm)
	DuraSled for S7	Weight: 3.84 oz (109.0 g) Size: L 6.17" x H 1.08" x W 2.84" (156.7 x 27.432 x 72.136 mm)
	Charging Dock	Weight: 16.9 oz (478.5g) Size: 7.33" x 1.12" x 3.23" (186.2 x 28.4 x 82.0mm)
	USB 2.0 Cable	1.2 meters (3'9")
LEDs	Scan LED: Green and Red Bluetooth LED: Blue	
Buttons	Scan Button: Scan Power Button: On/Off	

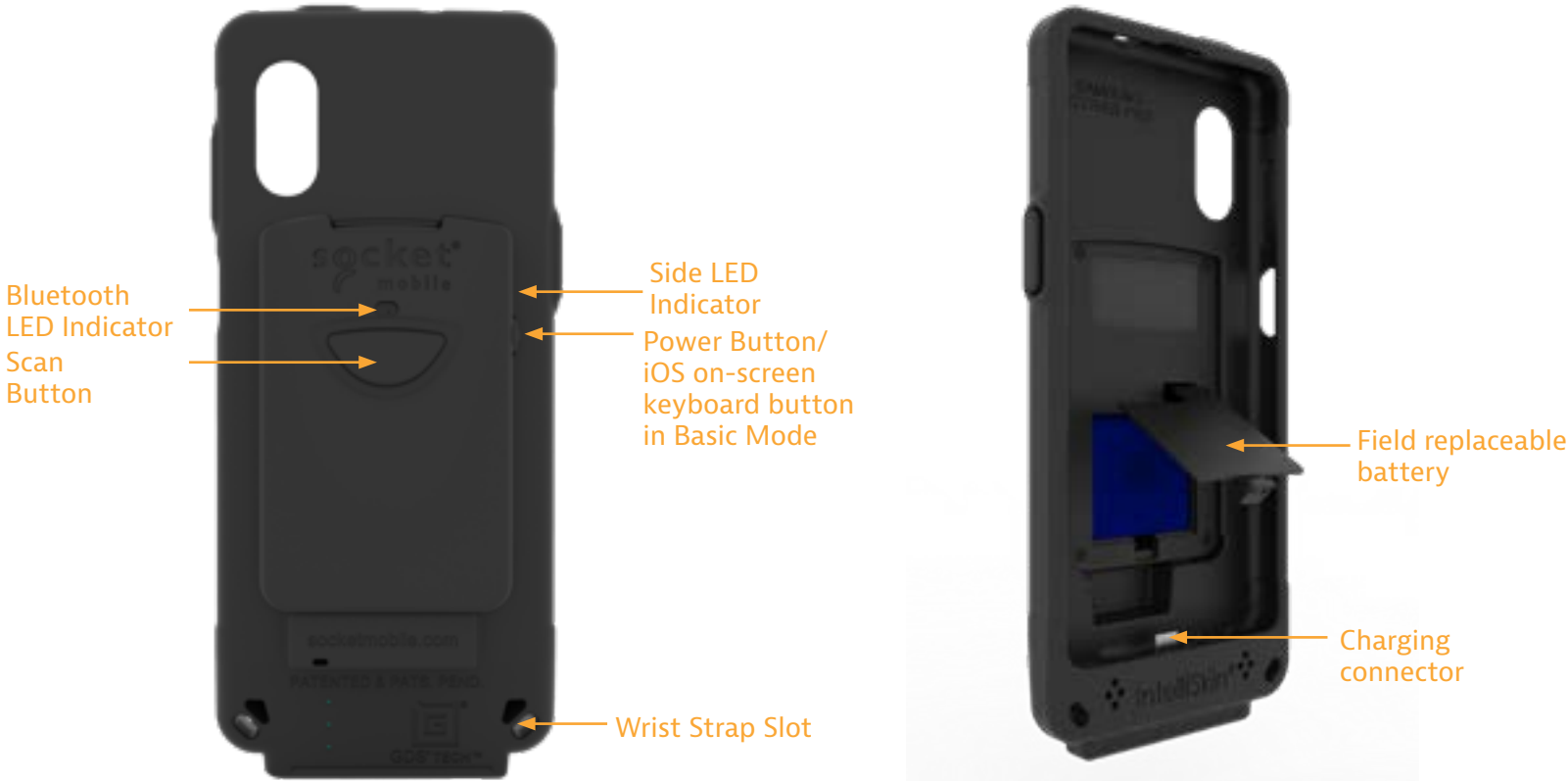

SCANNER TYPE

Technology:	2D/1D Barcode Imager
Lightsource:	1 hyper red 660 nm (nanometer) LED
Aimer:	610 nm LED

Default Barcode Symbologies:

1D Symbologies: Codabar, Code 39, Code 93, Code 128, EAN-13/JAN 13, EAN-8/JAN 8, GS1 Databar, GS1 Databar Expanded, GS1 Databar Limited, GS1-128, Interleaved 2 of 5, ISBT 128, UPC-A, UPC-E, UPC-E1

2D Symbologies: Aztec, Data Matrix, Maxicode, Micro QR Code, Micro PDF417, PDF417, QR Code

Postal Codes: USPS 4CB/One Code/Intelligent Mail

Supported Barcode Symbologies:

1D Symbologies: Bookland EAN, Chinese 2 of 5, Codabar, Code 11, Code 39, Code 93, Code 128, Composite CC-A/B, Composite CC-C, Composite TLC-39, Discrete 2 of 5, EAN-13/JAN 13, EAN-8/JAN 8, GS1 Databar, GS1 Databar Expanded, GS1 Databar Limited, GS1-128, Interleaved 2 of 5, Inverse 1D, ISBT 128, ISSN EAN, Matrix 2 of 5, MSI, UPC-A, UPC E/E-1

2D Symbologies: Aztec, Data Matrix, Han Xin, Maxicode, Micro PDF417, MicroQR, PDF417, QR Code

Postal Codes: Australia Post, Japan Postal, Netherlands KIX Code, UK Postal, UPU FICS Postal, US Planet, US Postnet, USPS 4CB/One Code/Intelligent Mail

Scan Angle:

42° (Horizontal) - 28° (Vertical)

Sensor Resolution:

640 horizontal x 400 vertical pixels

Print Contrast:

Down to 25%

Reading Distance:

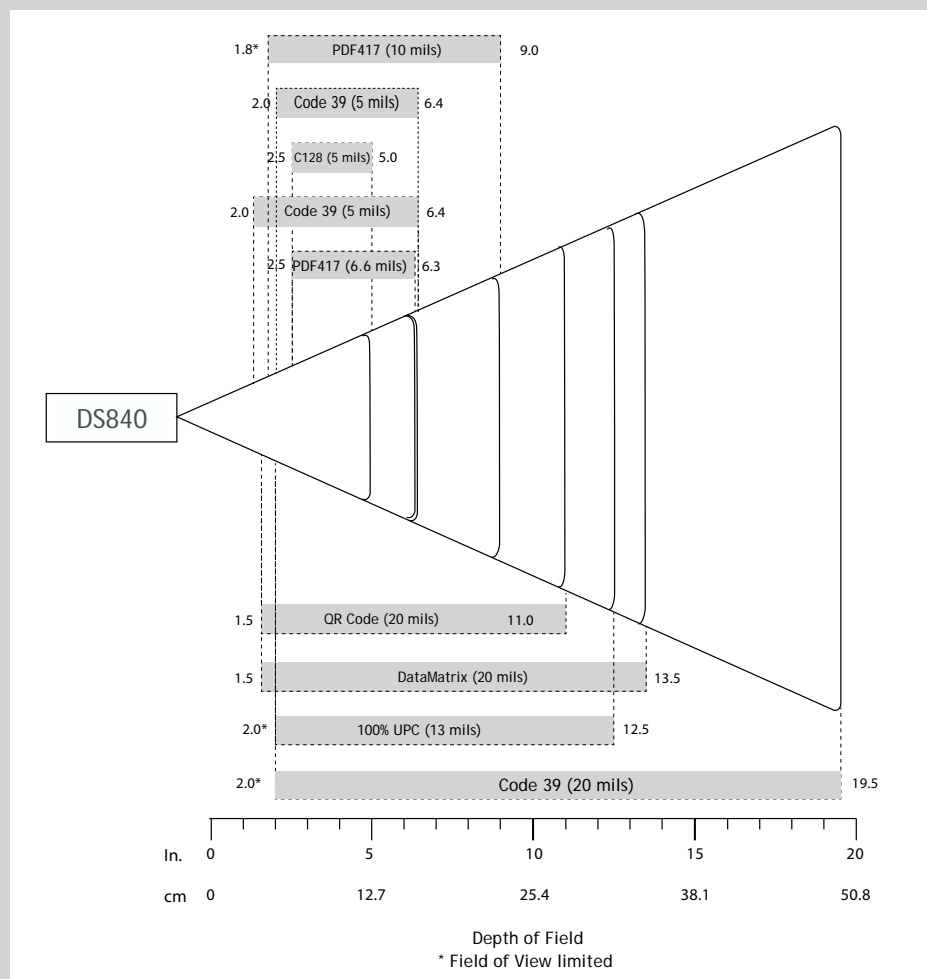

3.8 to 49.5 cm (1.5 to 19.5 in.) Depends on barcode size, symbology, label media, scan angle

Decode Ranges:

	Near	Far
5 mil Code 39	2.0 in/5.1 cm	6.4 in/16.2 cm
5 mil Code 128	2.5 in/6.3 cm	5.0 in/12.7 cm
6.6 mil PDF417	2.5 in/6.3 cm	6.3 in/16.0 cm
10 mil PDF417	1.8 in/4.5 cm*	9.0 in/22.8 cm
13 mil 100% UPC	2.0 in/5.0 cm*	12.5 in/31.7 cm
20 mil Code 29	2.0 in/5.0 cm*	19.5 in/49.5 cm
20 mil Data Matrix	1.5 in/3.8 cm	13.5 in/34.3 cm
20 mil QR Code	1.5 in/3.8 cm	11.0 in/27.9 cm

Type of Battery:	Lithium Ion Polymer- rechargeable field replaceable battery
Charge Time:	8 Hours
Battery Life:	500 charge-discharge cycles
Battery Life Per Full Charge:	Standby time: 25 hours Active Scan Time - 34,000 scans within 3 hours (based on 2 scans every 1 second) 9,000 scans within 10 hours (based on 1 scan every 4 seconds)
Note:	Battery life varies depending on ambient temperature, ambient light, age of battery, etc.
Number of Batteries Used:	1
Weight of battery:	12.5g
Percentage Lithium:	36%
Battery mAh:	700 mAh
Number of cells per battery:	1
Watt Hours per battery:	2.59
Type of Cell (ex. AA):	Proprietary
Chemical Composition (ex. Alkaline):	Lithium - polymer
Lithium Content:	14g
Battery Voltage:	3.7v
Hazmat UN Number:	UN3481, P.I. 967
ROHS Compliance Indicator:	Yes, Included with Scanner
Country of Origin:	China
Commodity Code:	8507.60.0000

COMMON USES

Retail	Hospitality	Point of Sale
Logistics	Life Sciences	Automotive
Healthcare	Inventory	Transportation
Warehouse Management	Field Sales & Service	

USER ENVIRONMENT

Ambient Light:	From 0 to 100,000 lux From pitch black to direct sun light
Operating Temperature:	+32 to +122°F (0 to +50°C)
Storage Temperature:	-22 to +158°F (-30 to +70°C)
Relative Humidity:	5% to 95% (non condensing)
Sealing:	IP40
Drop Specifications:	Multiple drops to vinyl covered concrete at about 3 ft or 1 m



Android OS: Basic Mode (HID) & iOS Application Mode*

Compatible with devices supporting Basic Mode (HID) protocol

Supported keyboard languages - ANSI, English UK, English, French, German, Italian, Japanese, Polish, Spanish and Swedish

**By default, the factory settings of the Socket Mobile Scanners are set to iOS Application Mode. In order to use the scanner with an application using Capture SDK, the scanner must be configured in App Mode (Bluetooth Serial Port Profile: SPP).*

BLUETOOTH (WIRELESS CONNECTION)

Bluetooth Radio:	Class 2 Bluetooth, version 2.1 + EDR (Enhanced Data Rates) with 56-bit data encryption
Bluetooth Range:	Up to 10 m (33 ft.) depending on environment, range limit is usually due to the Host Device (phone, tablet or notebook)
Bluetooth Profiles:	Basic Mode - Human Interface Device (HID) and iOS Application Mode*. Some Operating Systems or smartphone/tablet models may support only one profile. <i>*By default, the scanner is set to iOS Application Mode.</i>

CERTIFICATION & REGULATORY

Bluetooth SIG:	Declaration ID: D030473 QDID: 82009
Electrical Safety:	Certified to IEC 60950-1, UL 60950-1, CAN/CSA C22.2
Environmental:	RoHS EN 50581
EMI / RFI:	FCC Part 15 Class C, RSS 210, iCES 003, C-Tick, CISPR 22, CE EN55022, EN55024, TELEC
LED Safety:	IEC/EN 62471 (Exempt Group) FCC ID: LUBMA41 IC ID: 2529A-MA41S8 Telec ID:  201-125709

ISO 9001 Accreditation



WARRANTY

Scanner:	Standard one year limited warranty
Accessories:	Standard one year limited warranty
Extended Warranty: (sold separately)	www.socketmobile.com/socketcare



socketmobile.com

Worldwide:	+1 510 933 3000
North America:	+1 800 552 3300
EMEA & Russia:	+41 62 834 07 80
France:	+33 (801) 840504
Malaysia (Toll Free)	+60 (1800) 818234

sales@socketmobile.com

Asia Pacific:	+1 510 933 3122
Germany:	+41 62 834 07 80
Switzerland:	+41 62 834 07 80
Switzerland (Toll Free):	+41 (800) 898003
UK/Ireland/South Africa:	+44 (800) 0487363

sales-japan@socketmobile.com

Japan:	+8190 9808 0518
Japan (Toll Free):	+81 (800) 9190303
Latin America:	+1-510-933-3153
Taiwan (Toll Free)	+886 00801491497