

## Autoclavable Roswell



Autoclavable Roswell is extremely reliable and durable for harsh applications and meets autoclave requirements for use in the healthcare industry. It's designed for quick and convenient attachment and can be easily bolted or tie-wrapped to an asset.



Hi-Temp and  
Autoclave proof



180°C read orientation



Brackets for quick  
attachment and removal



IP69K



Superior chemical  
corrosion resistance



- Sterilizable surgical trays
- Medical devices
- Manufacturing Hi-Temp

[LEARN MORE>](#)

## Performance Characteristics

<b>Read range (handheld)<sup>1</sup></b>	Up to 11.5 ft (3.5 m)
<b>Read range (fixed)<sup>1</sup></b>	Up to 16.4 ft (5 m)
<b>Polarization</b>	Linear
<b>Mounting system</b>	Screws (rivet hole ø 0.19 in (ø 5 mm)), Cable tie

1. Performance based on standard testing methodologies. Performance may vary depending on environmental factors and reader output power.

## Functional Specifications

<b>RF protocol</b>	EPC global Class 1 Gen2
<b>Frequency</b>	902-928 (US) ; 865-868 (EU)
<b>IC type (chip)<sup>1</sup></b>	Alien Higgs-3
<b>Memory</b>	96-EPC bits, 64-bit unique TID, 512 -bit user memory
<b>Material</b>	Stainless steel

1. The chip data retention is up to 50 years, based on chip operating under general environment conditions.

## Radiation Pattern

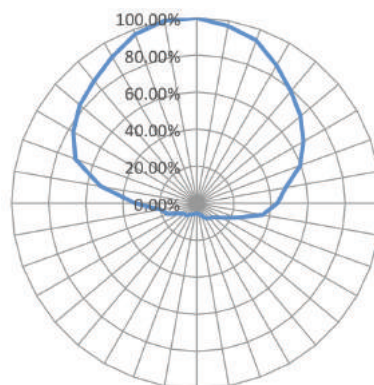

## Environmental Specifications

Operational temperature	-40°C to +85°C
Survival temperature	-40°C to +250°C
Chemical resistance	Various caustic chemicals <sup>1</sup>
IP rating	IP69K
Compression strength	1145 psi (7900 kPa)
Shock (drop)	3 ft (1 m) to concrete/granite
Vibration	MIL-STD-810G

1. The chemical resistance is based on the concentration of solutions and application environment. Please contact Xerafy for further details on chemical resistance.

## Industry Compliance

RoHS	EU Directive 2011/65/EU
CE	Yes
ATEX/IECEx	Compliant
Warranty	1 year
Healthcare sterilization compliance	ISO 17665 - Moist Steam, ISO 11135 - Ethylene Oxide

## Order Information

X1114-US141-H3	Autoclavable Roswell US
X1114-EU141-H3	Autoclavable Roswell EU
Optional service	Encoding / Printing / Laser etching



## Product Dimensions and Weight

Dimensions (in)	1.89 x 1.10 x 0.53
Tolerance	+/- 0.02
Dimensions (mm)	48 x 28 x 13.5
Tolerance	+/- 0.5
Weight	1.55 oz (44 g)

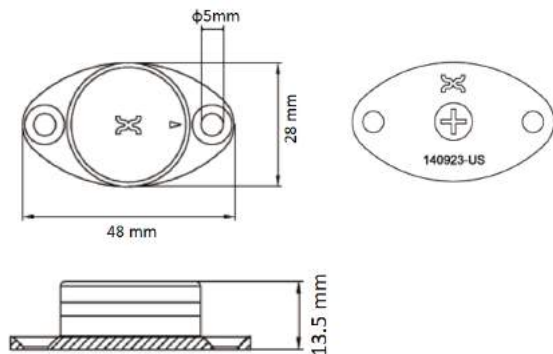

## Installation Instructions

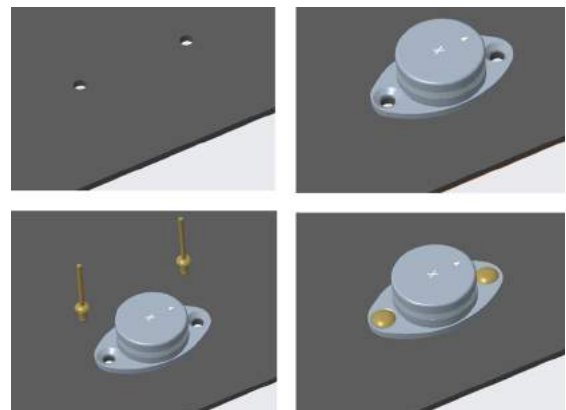

1. Put the tag orientation with symbol "X" in parallel to length of the metal surface.

2. When the tag is used in harsh environment, M4.8 screw /  $\phi 4.8$  rivet mounting is a suitable option. (screw hole: 0.19 in / 4.5 mm, rivet hole: 0.19 in / 5 mm)

## About Xerafy

Xerafy designs and manufactures the world's toughest RFID tags to power Industrial IoT applications in Aerospace, Oil & Gas, Automotive, Healthcare and Manufacturing.

For Product inquiries: [sales@xerafy.com](mailto:sales@xerafy.com)  
Singapore | China | US | UK

[GO TO WEBSITE >](#)